

The Wanderlust Rucksack



featuring fabrics from: **Coyote**



Thank you for choosing to sew along with us!
 We always have a great time Sewing Together at Hawthorne Threads and we're so glad you've decided to join the fun. For us its a wonderful way for our staff to connect with the fabric and, for some, to learn a lifelong skill while on the job. We endeavor to choose projects suitable for many skill levels so grab a friend or family member and get ready to sew together!

--WHAT YOU'LL NEED--

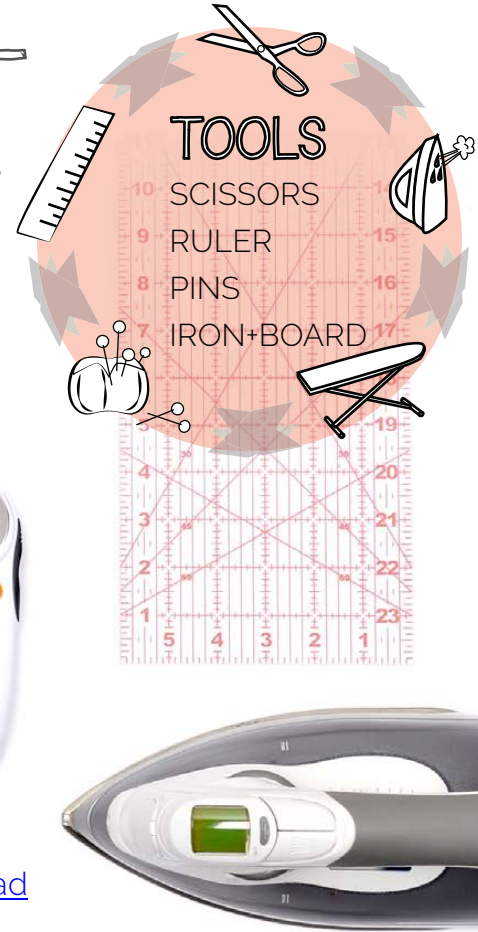

| YARDAGE NEEDED | |
|--------------------------|---------|
| From pre-washed fabrics: | |
| FABRIC A | 1 yard |
| FABRIC B | ½ yard |
| FABRIC C | 1 yard |
| FABRIC D | 1 yard |
| INTERFACING | 1¾ yard |
| FLEECE | ¾ yard |
| PELTEX | ¾ yard |

--DIMENSIONS--

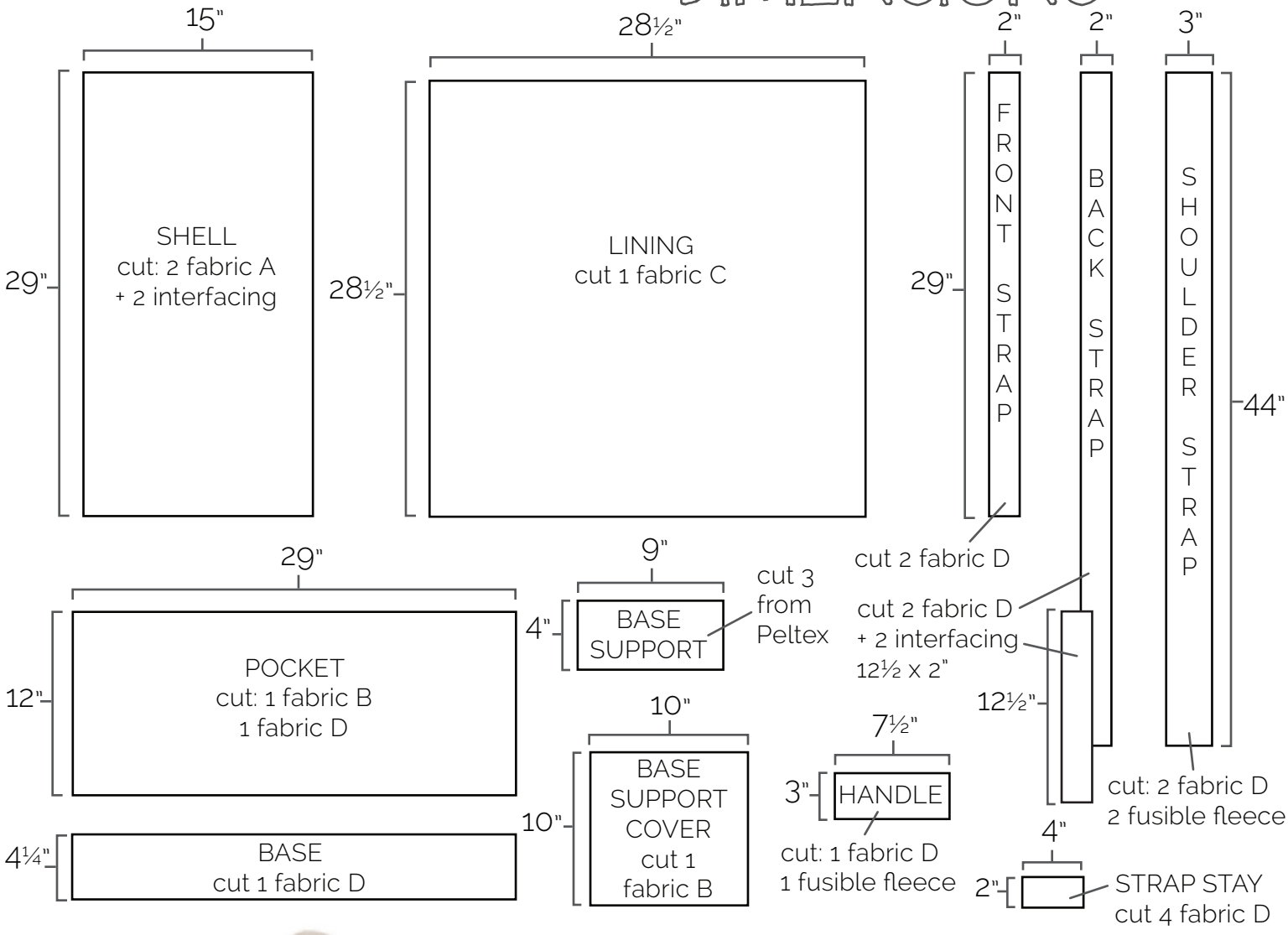

FINISHED PIECE



1

Cut pieces from fabric, fusible interfacing, fleece, and Peltex. You should have:

- 2 exterior shell pieces + interfacing
- 1 lining piece
- 1 pocket exterior
- 1 pocket lining
- 1 base piece
- 2 front straps
- 2 back straps + interfacing
- 2 shoulder straps + fusible fleece
- 1 handle piece + fusible fleece
- 4 strap stays
- 3 Peltex base support pieces
- 1 base support cover

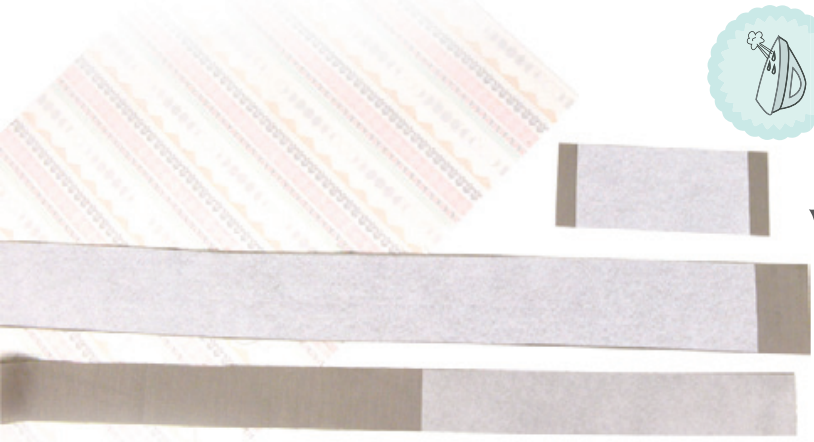

Iron on interfacing and fusible fleece to exterior, straps, and handle.

2

Trim ends from fusible fleece pieces:

- $\frac{3}{4}$ " from each end of handle
- 1" from top end, 2" from bottom end of both shoulder straps

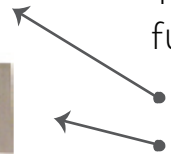

3

Prep front and back straps:

- Press front and back straps in on each side so that edges meet in the middle, right side out. Straps should be 1" wide.

Fold one end of each back strap onto itself at interfacing edge $12\frac{1}{2}$ " from end + press.



Edgestitch the sandwiched section of the strap together $\frac{1}{8}$ " from edge of fabric.

Sew a buttonhole centered $\frac{3}{4}$ " from the end of the sandwiched strap.



Prep shoulder straps, strap stays, and handle piece:

- First turn one side in 1/4" lengthwise (skip this on the strap stays.) Then, fold into thirds + press, covering the raw edge and centering the turned edge on top. →

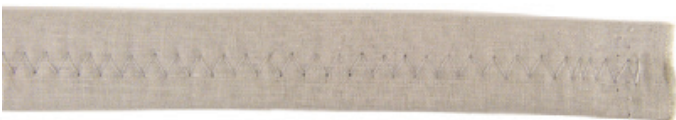

Using a wide zigzag stitch, sew down the center securing the turned edge at the back.



Slide a strap slide over the bottom end of the shoulder strap (the one with 2" of fleece trimmed.)

Fold the edge over 1/2" and create a loop by pinning it back onto the strap + sew down.

4

Use 1/2" seams.

Sew shell pieces together at side seam, right sides together.



Press seam open.

On the top edge of the pocket exterior piece, find center point + mark. Measure 3 1/2" out from either side of center + mark.

Center zipper about 1/4" below these marks + pin. →

Trim zipper if needed!

5

Using zipper foot, baste on zipper, then sew pocket exterior to pocket lining, right sides together.



Turn + press flat so that zipper sticks up from the top edge. Topstitch pocket hem 1/8" and 1/2" from edge.

Align bottom edges of pocket and shell.

Mark where top edge of the zipper teeth fall on shell.

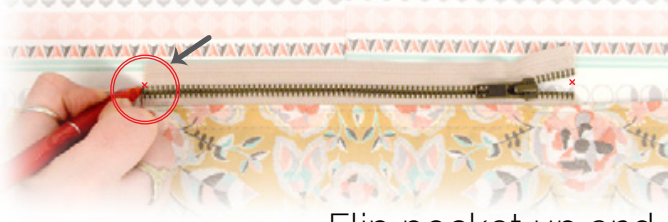

Flip pocket up and align the corners of the zipper tape to the placement marks. Pin + sew.



Flip pocket back over, again lining it up with the bottom edge of shell.

Press flat + baste together along bottom edge just inside seam allowance at 3/8"



Place the shell right-side-up on your workspace.



Along both the top and bottom edges, measure $3\frac{1}{2}$ " and then $10\frac{1}{2}$ " out from either side of the side seam + mark.

Find your prepared front straps and position them vertically, centered over the lefthand placement marks. Pin down securely.

Edgestitch down $\frac{1}{8}$ " from strap edges, enclosing the end of the zipper under the strap.

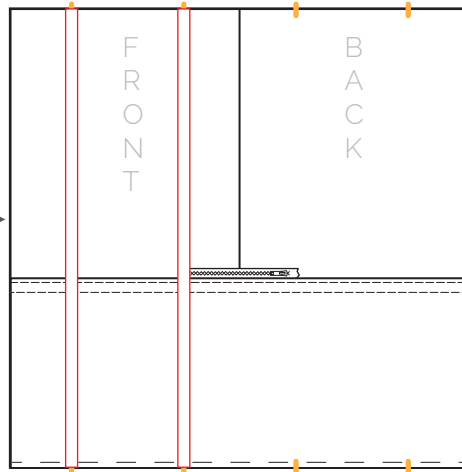
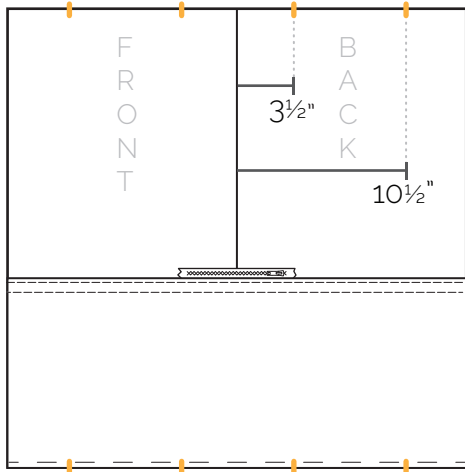

Make sure the free end of the zipper is folding downward toward the pocket hem, so that the teeth just about meet.

Next, position back straps vertically, centered over righthand placement marks + pin.

Edgestitch down like you did the front straps, but this time, when you reach where the strap is folded and sewn, continue past the raw edge about $\frac{3}{4}$ " then stop. With the needle still in the fabric, turn and sew perpendicularly across strap and continue sewing a box stitch over the section where the strap is doubled up. Continue down opposite side of the strap to complete.

Use hand wheel when sewing over zipper!

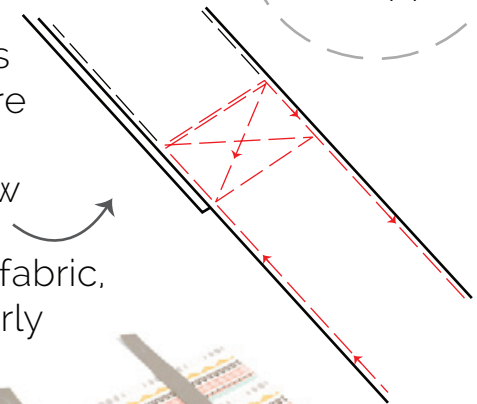
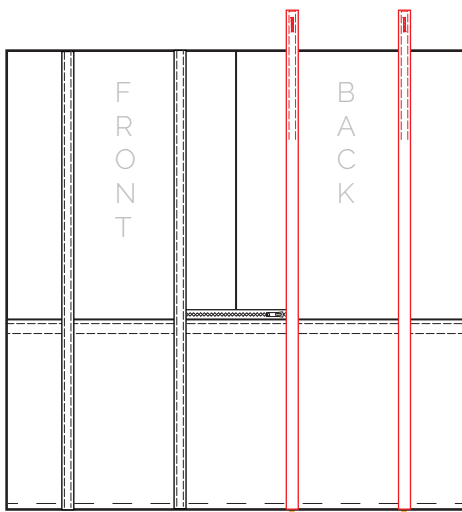

Mark 1" and 8½" up from top of pocket on either side of the front straps.

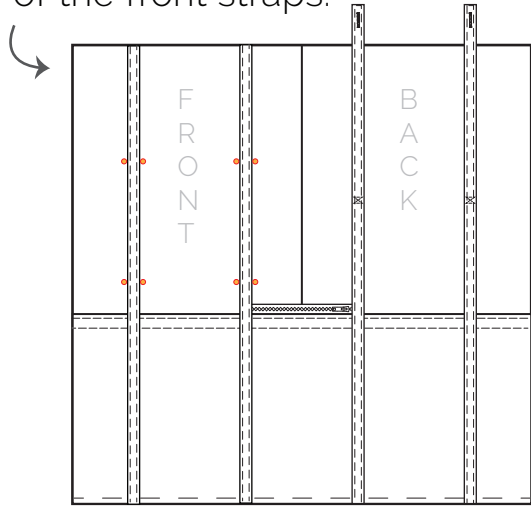

Turn all of the strap stay ends under ½" + press. Position parallel to pocket hem with turned edges on either side of the straps and centered over the placement marks, pin.

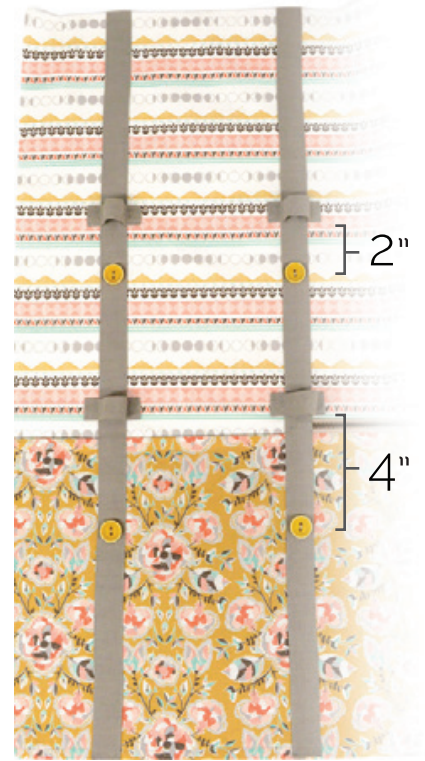

Sew on buttons 2" below the top stays and 4" below the bottom stays, centered on top of the front straps.



Sew down turned edges with box stitches, the stays should bubble up a bit from the shell.



Position shell right-side-up, measure + mark 3¾" up from bottom.



Layer base piece onto shell right-side-down with its bottom edge aligned with the placement marks. Sew down ¼" from edge.



Fold piece over at this seam + press flat.

Bottom edges of shell, pocket, and base should all be aligned.

Baste together all bottom edges. Trim the bulk from the seam allowance at bottom edge of shell and pocket, keeping base piece in tact.

Edgestitch along folded edge to secure.

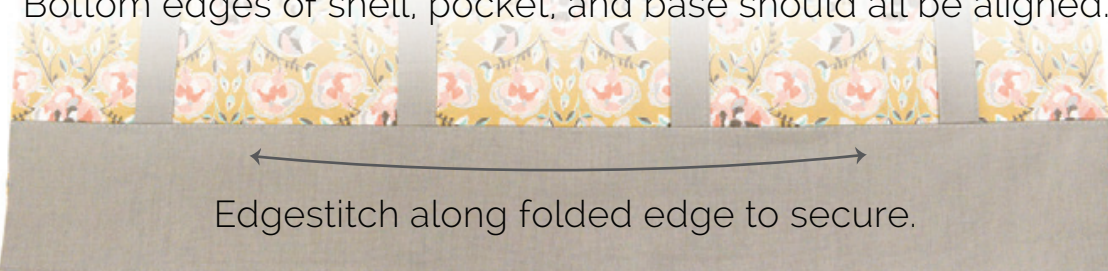

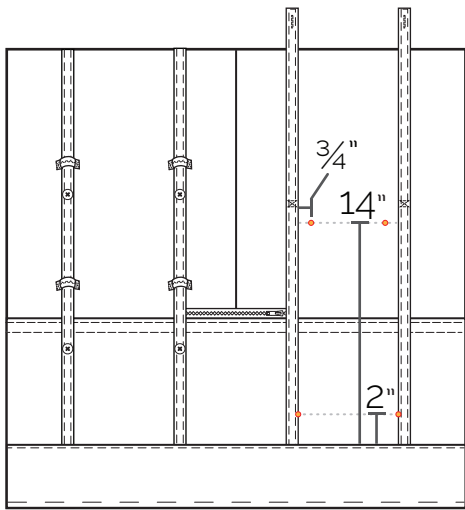

Again, begin with shell right-side-up. Measure and mark strap and handle placement up from top edge of base on the back side of the shell using the specifications shown here.

Also mark placement guides along the inner sides of each strap at 2½" from the edge of the strap slide end.

Facing right-side-down, bend handle as shown and line up each outer corner with the placement marks 14" above base top edge. Let the ends angle evenly toward the shoulder strap placement marks below. Pin + tack in place.



Position strap right-side-down so that the guide on the strap touches the placement mark on the shell. Angle the strap so that it lines up with the end of the handle + pin.



Edgestitch around strap edge, sewing a box stitch in the ¾" overlap at the handle to secure.



Feed the long upper end of shoulder strap through the strap slide, turn end under ¼" then again at the edge of the fleece + sew with a box stitch.





Line up seam allowances of shell + pin. Base and pocket edges should match up.

Tuck straps and handle in as far as you can so that you don't accidentally trap one in your seam.



Sew up seam + press open.



Trim seam allowance from pocket and base pieces to about 1/4" to remove some bulk from the seam.



Next, flatten the bag at the seams and pin along the bottom edge. Sew + press towards the back.



To box the corners, flatten the base and center the bottom seam. Mark 3" from the corners along each side. Connect the marks to section off each corner.



Pin + sew across the guidelines.



OPTIONAL: Add any pockets you would like to the lining now. Remember, the top will roll down, keep pockets below 10" from top of lining.



Complete the lining in the same basic way as the shell, sew up side and bottom seams and box the corners, seam pressed toward front.

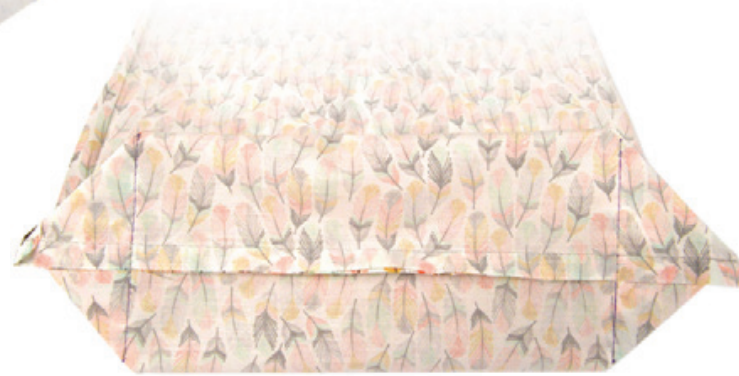

Turn shell so that the right side is facing out and the lining so that the wrong side is facing out.

Tuck lining into the shell, wrong sides together.

Align corners at the base.

The remaining raw edge will be sewn with a flat-felled seam.

Here's how!

Flat-felled seams are most often used on side seams, ours is modified slightly to complete the top hem.

First, line up side seams, center lines, and top edges of shell and lining + pin.
From the right side, topstitch around edge using a 1" seam allowance, easing the shell in slightly.



Trim away about half of the seam allowance of lining only. →



← Fold seam allowance of shell down over the seam allowance of the lining so that it meets the seam line + press.

Then, fold over once more so that the raw edges are covered and you can see the seam on the inside of the bag. Press + pin.



From the outside of the bag, topstitch along folded top edge at 1/2" + press.

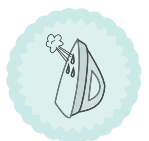

11

For a sturdy bottom, fuse the three pieces of Peltex together.

Fold the base support cover piece in half, right sides together.

Sew along two of the three open edges at $\frac{1}{4}$ ", leaving one of the shorter ends open.



Turn right-side-out and press seams flat.

← Slide the three layers of Peltex into the pouch. Turn the loose seam allowance in, press, and sew up the opening. →



Tuck completed base support into the bottom of your bag + roll it up!



CONGRATULATIONS!
YOU'VE FINISHED YOUR RUCKSACK!

Share it with us on our Facebook page or Instagram using #HTSEWINGTOGETHER